

# WAVEPACE®

## Armored patch cords No more undercutting of the bending radius!



### Undercutting the bending radius is a thing of the past!

Today, many service calls within FTTH networks find its source in the customer in-home network. Experience teaches us, that, apart from un-powered CPEs, in most occasions the fiber patch cord connecting the passive FTU with the fiber CPE is causing the service call.

Everything goes well with the installation, until the time the customer decides to "re-wind" the patch cords with overlength. Most of the time, the customer does not take the patch cord's minimal bending radius into account, and in some cases undercutting the bending radius even causes the fiber to break.

**To overcome unnecessary and costly service calls and truck rolls, we have designed an LSZH steel armored patch cord so robust that bending radius issues or broken fiber cords are things of the past.**

During development we learned, that stiff white-colored patch cords, looking like standard RF flyleads, are treated with more care by the customer than the standard yellow ones. For the customer it is more easier to determine that this patch cable is part of the internet and TV services network.

These high-end subscriber patch cables are equipped with high-quality grade B connectors by default, and are 100 % cleaned and tested before leaving our production facility. On request, the patch cords can be delivered with individual labeling, defined by the operator.

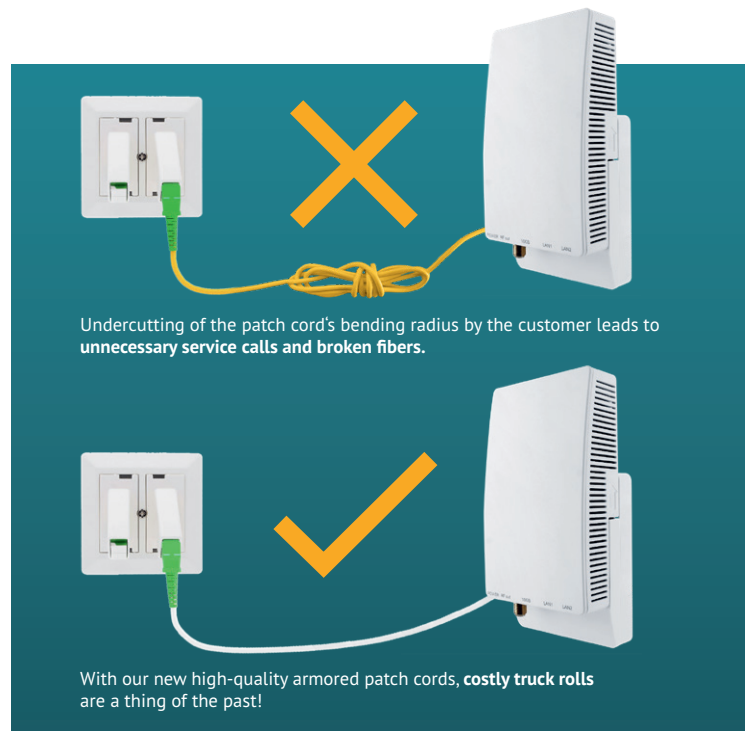

### No more unnecessary and costly truck rolls due to broken fibers!

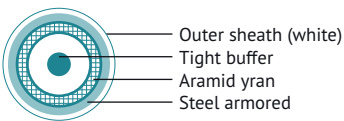

	OJS-xx-SC/APC-SC/APC	OJS-xx-LC/APC-SC/APC	OJS-xx-LC/APC-LC/APC
Patch cord type	Simplex LSZH steel armored customer premises fiber patch cable		
Cable color	White		
Cable diameter [mm]	3,0		
Minimum bending radius [mm]	30		
Insertion loss [dB]	≤ 0,25		
Return loss [dB]	> 65		
Fiber type	SM G657.A2		
Available cable lengths [m]	1,0 / 1,5 / 3,0 / 5,0		
	For choosing a cable length, please replace the „xx“ in the item name with the desired cable length.		
Connectors	2 x SC/APC, 8°, Grade B	1 x LC/APC, 1 x SC/APC, 8°, Grade B	2 x LC/APC, 8°, Grade B

**Different connector types, lengths and cable colors are available on request.**

Subject to technical changes. Version 1.0



The entire WAVEPACE® product range and a list of sales partners is available at [www.wavepace.com](http://www.wavepace.com)

Do you have any questions about WAVEPACE® products? Please send us an email to [info@wavepace.com](mailto:info@wavepace.com)